

4 Install the V-Blocks

Position the transducer cable through the **V-Block** (5).

Install the V-Block into the **T-Track Cover** (4).

Install the 4 **V-Block Screws** (6).

Repeat this process for the second **V-Block**.

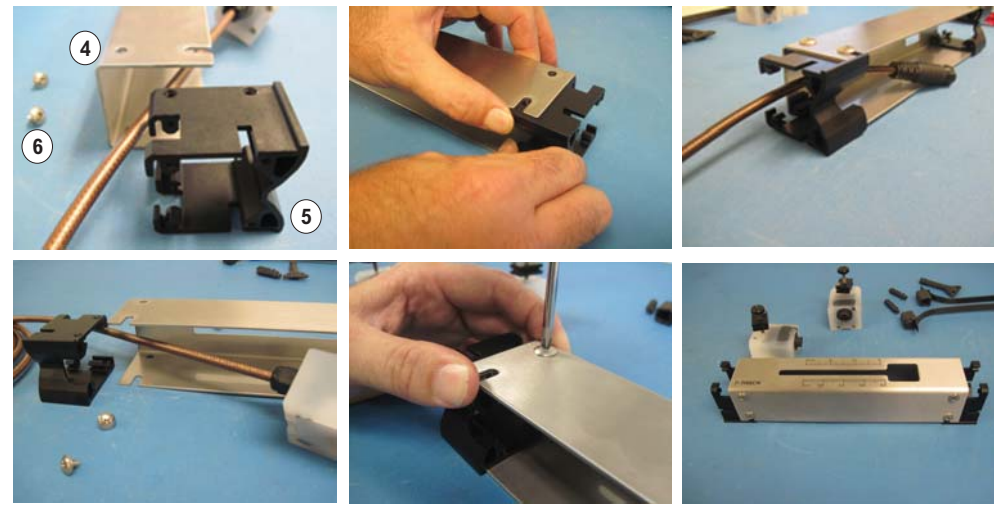

5 Install and Position the Transducers in the T-Tracks

Insert the first transducer's **Retainer Slide Nut** (1) through the square opening in the underside of the first **T-Track Cover** (4). Align the grooves in the **Slide Nut** with the slot in the **T-Track Cover**. Slide the transducer assembly over to the zero position and lock in place with the **Positioning Set Screw** (2).

Insert the second transducer's **Retainer Slide Nut** (1) through the square opening in the underside of the second **T-Track Cover** (4). Align the grooves in the **Slide Nut** with the slot in the **T-Track Cover**. Slide the transducer assembly over to the correct separation distance position (see step 2) and lock in place with the **Positioning Set Screw** (2).

Be sure one of the transducers is facing away from the zero set-point and the other is facing toward the zero set-point. The cables should be facing away from each other.



6 Adjust the Tensioning Thumb Screws

Adjust the **Tensioning Thumb Screws** (2) counter-clockwise so that the transducers are fully inside the **T-Track Cover** (4) as shown.

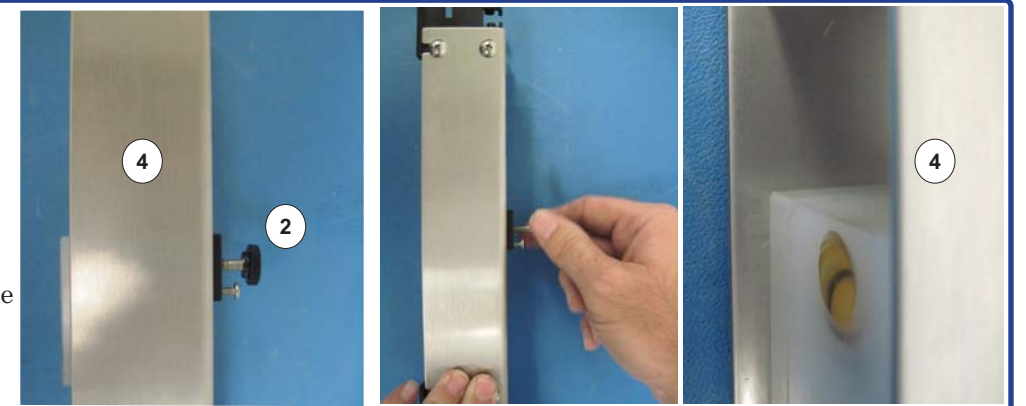

7 Apply Acoustic Coupling Material

An acoustic coupling material must be placed between the transducer and the pipe surface at the point where the sound waves enter the pipe. Place a drop of **DOW 111 grease** or the permanent **Blue Gasket pad** on the oval shape waveguide.



DOW 111 Silicone Grease
or
BLUE GASKET - Permanent installations. Recommended for metal pipes.



8 Install the Pipe Clamps

Attach **strap clamps** (8) to pipe. Thread strap through ratchet mechanism and tighten loosely.



9

Install the T-Track on the Pipe

Position the T-Tracks on the side of the pipe - do not install on the top or bottom of the pipe.

Insert the first **Pipe Clamp** (7) into the slot in the **V-Blocks** (5). Insert the second **Pipe Clamp** (7) into the slot in the **V-Blocks** (5) on the other side of the T-Tracks.

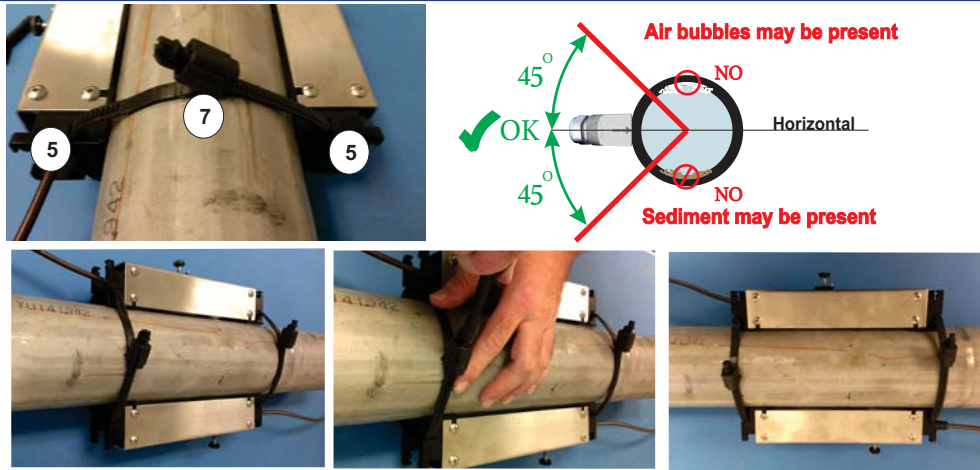

10

Install the Alignment Bars

Install the **Alignment Bars** (11) into the slots on the **V-Blocks** (5), tighten the **Thumb Screws** (13)



11

Install the Alignment Rods

Insert the **Alignment Rods** (12) into the **Alignment Bars** (11). Tighten the **Clamps** (7).

The **Alignment Rod** can be extended for up to 24" pipe.

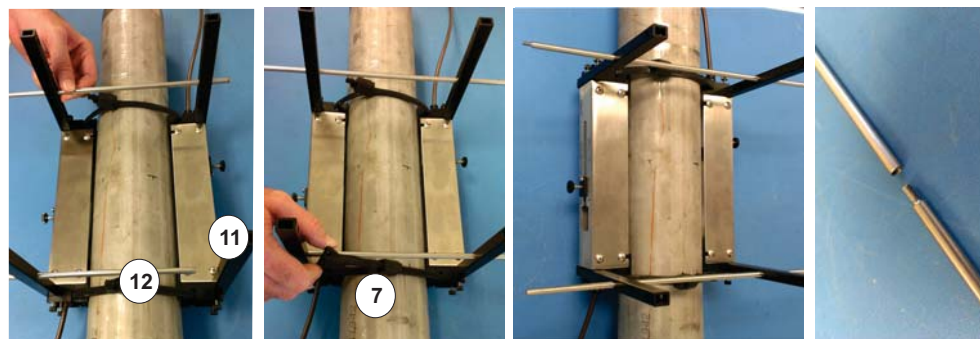

12

Tension the Transducers against the Pipe Surface

Tighten the **Tensioning Thumb Screws** (3) by turning clockwise.

Confirm the **Retainer Slide Nuts** (1) are positioned to the correct separation distance per step 2.

Alignment Bars and **rods** may now be removed.

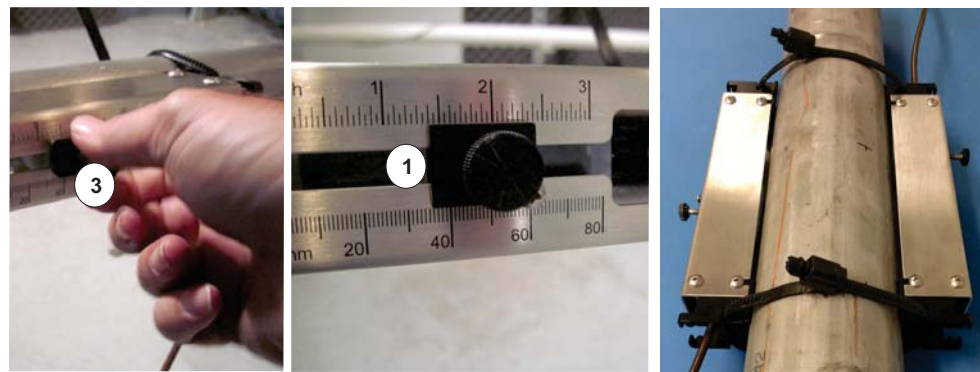

Transducer Track Installation Guide - Z-Mount method

1

Parts Locator

Locate the T-Track assembly package and your Transducer set. The package should contain the following items:

- 1) Retainer slide nut (2)
- 2) Positioning set screw (2)
- 3) Tensioning thumb screw (2)
- 4) T-Track cover (2)
- 5) V-Block (4)
- 6) V-Block screw (16)
- 7) Pipe clamp (2)
- 8) Pipe clamp screw (2)
- 9) Pipe clamp wrench (1)
- 10) Installation guide (1)
- 11) Alignment bar (4)
- 12) Alignment rod (2)
- 13) Alignment bar screw (8)

Note the serial number location on the transducer.



2

Determine Separation Distance

If not already done, configure the meter for the pipe application. The meter's display screen will display the transducer separation distance.

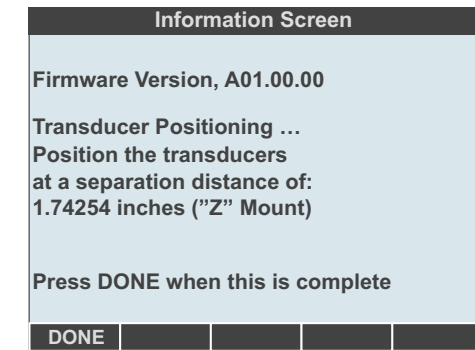

3

Install Retainer Slide Nut Assembly

Install the **Positioning Set Screws** (2) and the **Tensioning Thumb Screws** (3) into the **Retainer Slide Nuts** (1).

There is a captured nut located inside transducer housing. While holding the captured nut with a small screwdriver, thread the thumb screw into the captured nut. Do not over-tighten.

